

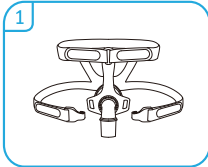

Mask Fitting Guide

N5+ Nasal Mask

Fitting your Mask



Release the lower clips



Place Mask on Face

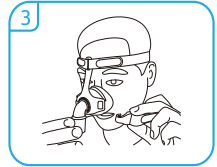

Clip Lower Straps

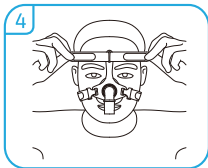

Adjust Upper Straps

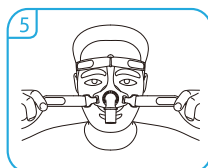

Tighten Lower Straps

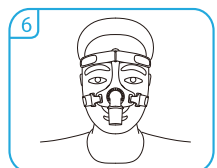

Final Seal Check

Disassembling the Mask



Undo and remove the upper headgear straps out of the hole on the frame.

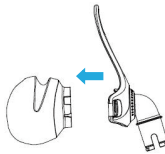

Remove the cushion assembly from the frame assembly.

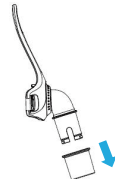

Remove the swivel from the frame assembly.

Reassembling the Mask

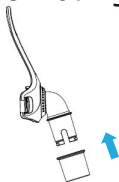

Install the swivel onto the frame assembly and confirm that the swivel is reliable.

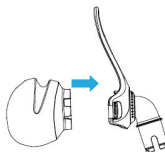

Install the cushion assembly onto the frame assembly and confirm that the cushion assembly is reliable.



Install the upper-half headgear onto the upper-half installation hole of the frame assembly.



Cleaning Guide

N5+ Nasal Mask



Daily Care

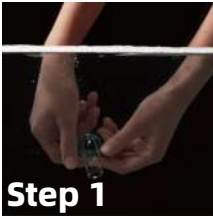

Step 1

The components should be soaked in a mild liquid detergent solution (as dishwashing liquid) with drinking-quality water (25°C to 35°C) for 10 minutes.



Step 2

Please gently clean with a soft-bristled brush, paying particular attention to crevices and cavities.



Step 3

Rinse the components thoroughly with clean water.



Step 4

Ensure the components be air-dried in a location that is not exposed to direct sunlight.

Weekly Care



Step 1

The headgear should be hand washed in a mild detergent solution (as dishwashing liquid) for 10 minutes.



Step 2

Ensure thorough rinsing and allow for complete air-drying, avoiding direct sunlight.